

I,

Promise to brush my teeth every day and floss  
just like Flossie the ferret!

(print your name here)

(sign your name here)

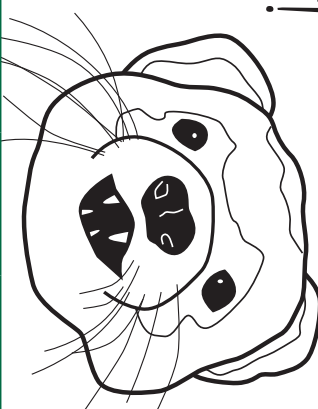

© 2007 Sacramento District Dental Society

Flossie  
the ferret

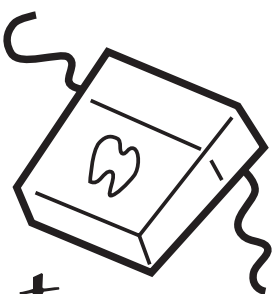

Brought to you by Sacramento District Dental Society & Sierra Health Foundation

© 2007 Sacramento District Dental Society

# What is a Ferret?

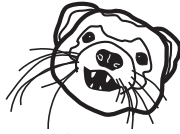

- The ferret is a very close and silly relative of the weasel, polecat and the mink. Ferrets are also related to otters, skunks and badgers. They are all part of the Mustelidae family.
- Ferrets are not related to rodents. They are carnivores. In fact, wild ferrets enjoy a tasty mouse. All Mustelidae have various scent glands for marking and protection (like the skunk)!
- Ferrets are energetic, curious, and always interested in exploring their surroundings.
- **What else can you find out about ferrets?**

# Word Match

Can you find the word that goes with each picture?  
Draw a line from the picture to its matching word.  
Try to find all 4 matches!



TOOTHPASTE

TOOTHBRUSH

TOOTH

FLOSS

# Draw your dentist!

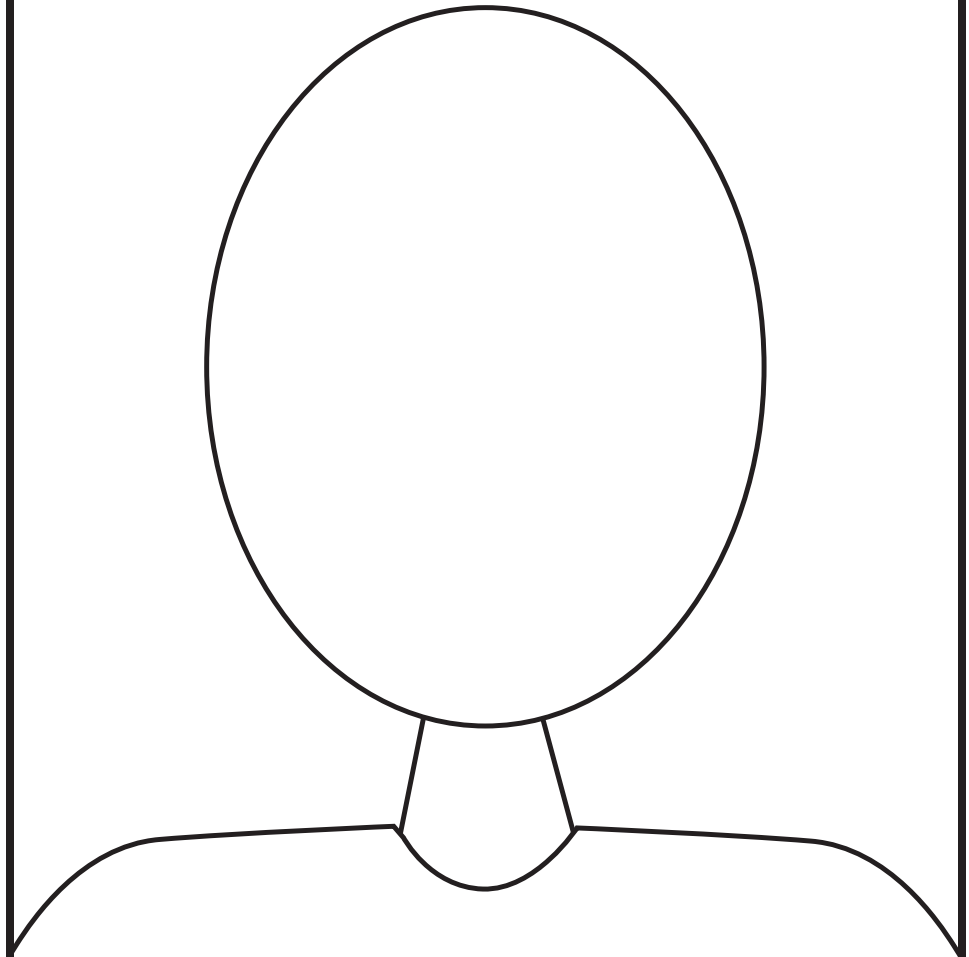

open wide,  
so the dentist can  
see your teeth.



Will you help  
me find my  
toothbrush?

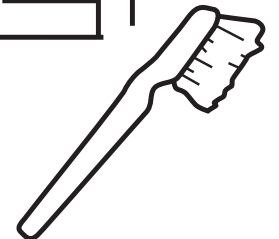
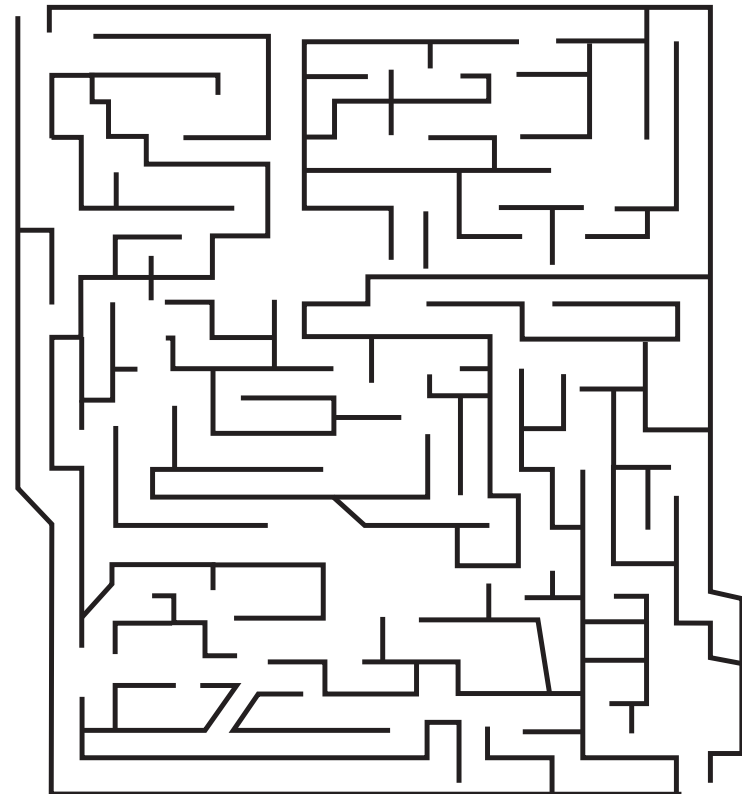

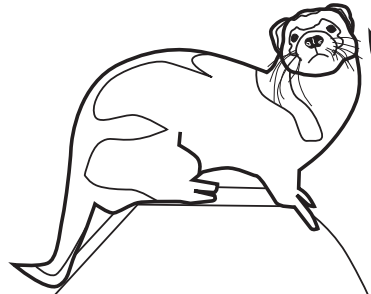

Circle the things that are good for your teeth, and "X" the things that are bad for your teeth.

# The Dental Office

Learn about the tools your dentist uses to give you a great smile!

## X-Ray Machine

This is a special camera that takes pictures of the inside of your mouth.

## Saliva Ejector

This mouth vacuum helps the dental hygienist keep your mouth dry so she or he can clean your teeth.

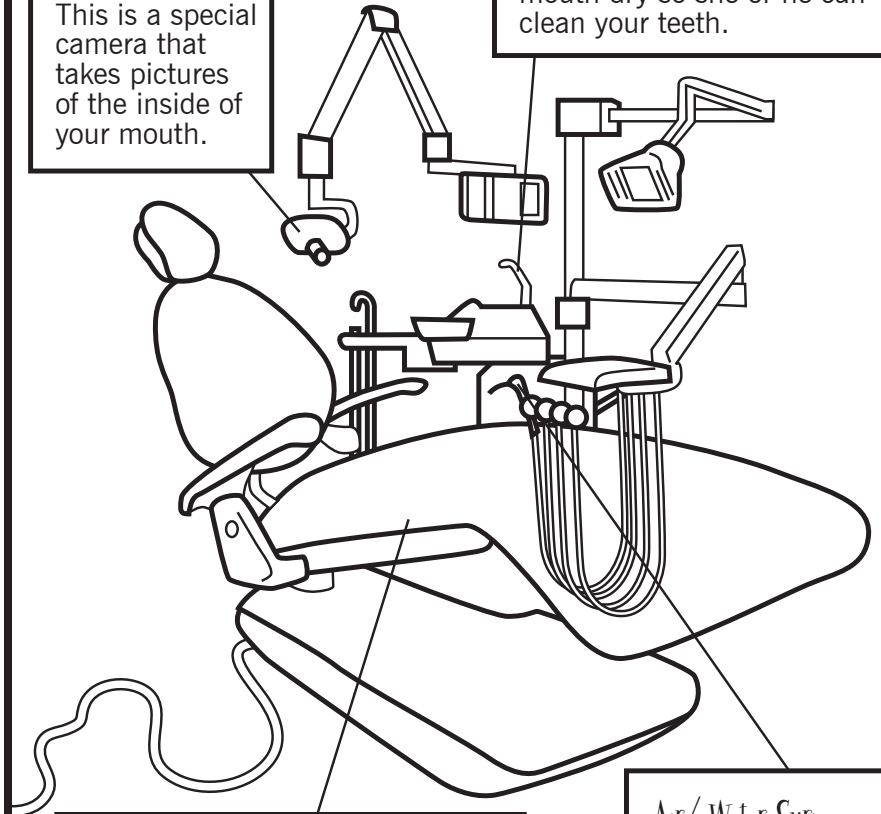

## Chair

This is a special kind of chair. It moves up and down and leans way back so the dental hygienist and dentist can reach the teeth at the back of your mouth.

## Air/ Water Syringe

The dental hygienist uses it to squirt water and air into your mouth (like a squirt gun!) as she is cleaning your teeth.